

INTERIOR WALLS

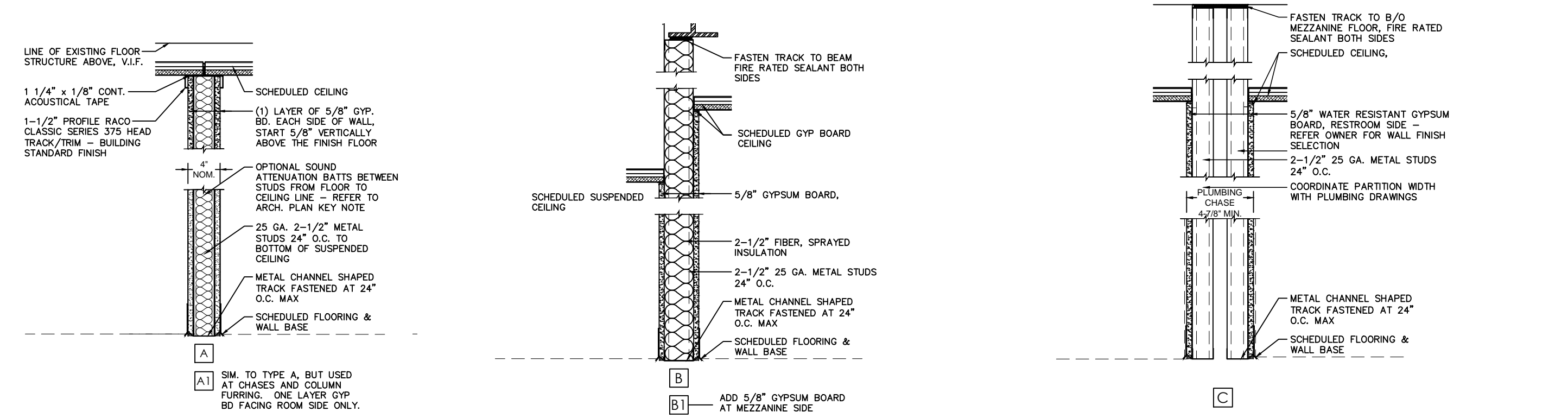

EXTERIOR WALLS

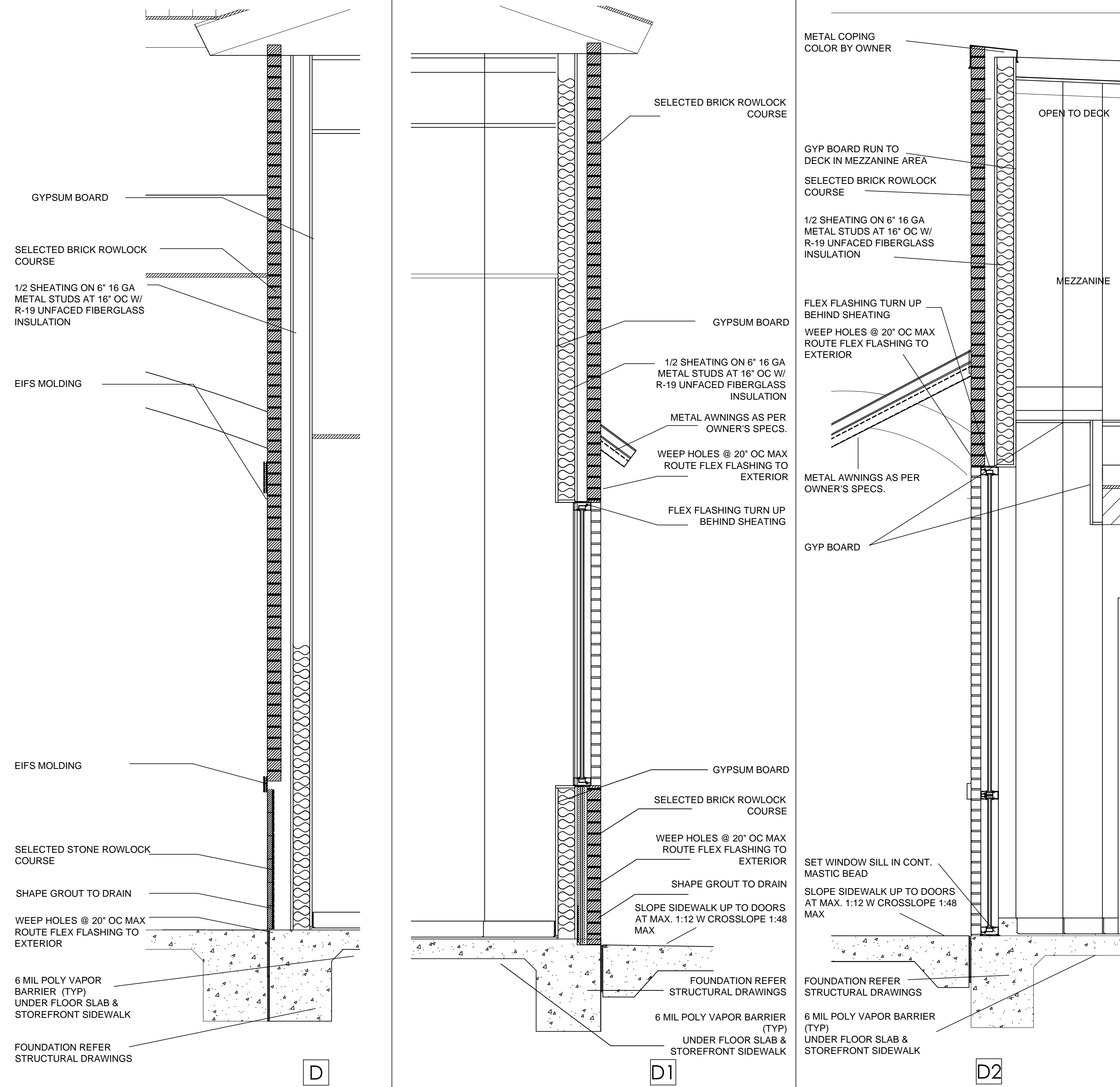

WALL SECTIONS

N.T.S

04

GENERAL WINDOW NOTES:

- OVERALL DIMENSIONS ON WINDOW FRAME ELEVATIONS INDICATE ROUGH OPENING SIZE. LOCATIONS MAY BE SLIGHTLY DIFFERENT. SIMILAR AND/OR OPPOSITE. FIELD VERIFY DIMENSIONS PRIOR TO FABRICATING COMPONENTS. ANY DISCREPANCIES OR ALTERATIONS SHALL BE REVIEWED WITH ARCHITECT & STRUCTURAL ENGINEER PRIOR TO PROCEEDING. REFER TO ARCHITECTURAL FLOOR PLANS, ELEVATIONS, AND SECTIONS FOR DETAIL LOCATIONS & TYPE OF MATERIAL SURROUNDING WINDOWS.
- WINDOW DETAILS ARE NOT PROVIDED. CONTRACTOR MUST ADHERE TO MANUFACTURER PREFERRED INSTALLATION PROCEDURES FOR FRAME AND GLAZING NOTED.
- REFER TO STRUCTURAL DRAWINGS FOR ALL HEADER, LINTEL & SILL PLATE SIZES, LOCATIONS & SPECIFICATIONS. ALL NEW STRUCTURAL MEMBERS ARE TO BE MINIMUM OF 1 HR. FIRE RATED.

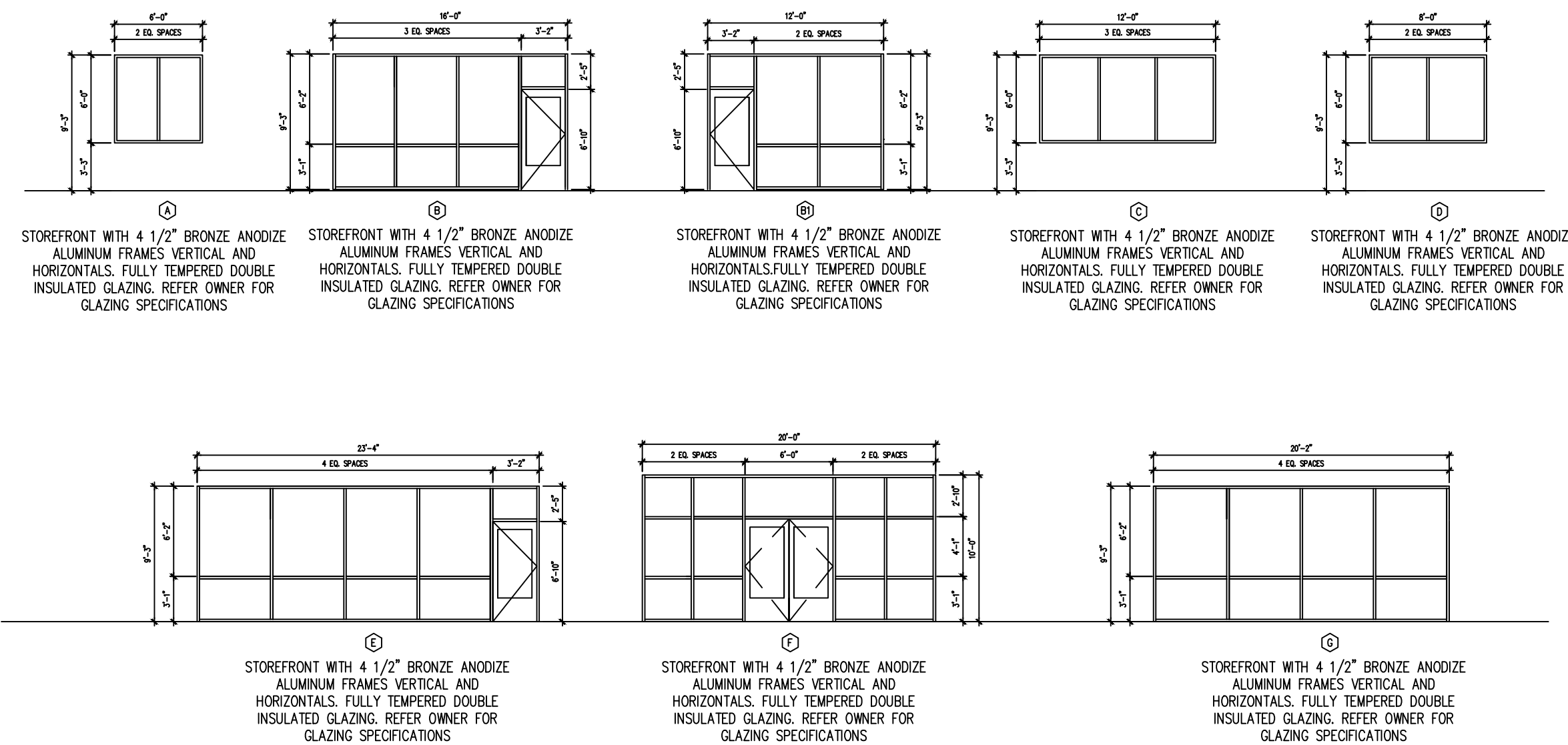

WINDOW SCHEDULE

NOT TO SCALE 03

TYPICAL DOOR NOTES:

- DOORWAYS SHALL HAVE A MINIMUM CLEAR OPENING OF 32" WITH THE DOOR OPEN 90 DEGREES, MEASURED BETWEEN THE FACE OF THE DOOR AND THE OPPOSITE STOP. THE BOTTOM 10" OF ALL DOORS SHALL HAVE SMOOTH UNINTERRUPTED SURFACE FOR OPENING BY WHEELCHAIR FOOT RESTS. ALL DOOR INSTALLATIONS MUST COMPLY WITH A.D.A. STANDARDS.
- HANDLES, PULLS, LATCHES, LOCKS, AND OTHER OPERATING DEVICES ON ACCESSIBLE DOORS SHALL HAVE A SHAPE THAT IS EASY TO GRASP WITH ONE HAND AND DOES NOT REQUIRE TIGHT GRASPING, TIGHT PINCHING, OR TWISTING OF THE WRIST TO OPERATE. LEVER-OPERATED MECHANISMS, PUSH-TYPE MECHANISMS, AND U-SHAPED HANDLES ARE ACCEPTABLE DESIGNS. MAXIMUM EFFORT TO OPERATE DOORS SHALL NOT EXCEED 8.5 POUNDS FOR EXTERIOR DOORS AND 5 POUNDS FOR INTERIOR DOORS WITH A PULL OR PUSH EFFORT BEING APPLIED AT RIGHT ANGLES TO HINGED DOORS, AND AT THE CENTER PLANE OF SLIDING OR FOLDING DOORS. COMPENSATING DEVICES OR AUTOMATIC DOOR OPERATIONS MAY BE UTILIZED TO MEET THE ABOVE STANDARDS. WHEN FIRE DOORS ARE REQUIRED, THE MAXIMUM EFFORT TO OPERATE THE DOORWAY MAY BE INCREASED NOT TO EXCEED 15 POUNDS WITH CLOSURE.
- THE SWEEP PERIOD OF ALL CLOSERS SHALL BE ADJUSTED SO THAT FROM AN OPEN POSITION OF 90 DEGREES, THE TIME REQUIRED TO MOVE THE DOOR TO A POSITION OF 12 DEGREES FROM THE LATCH IS 5 SECONDS MINIMUM.
- THRESHOLDS AT DOORWAYS SHALL NOT EXCEED 1/2" IN HEIGHT. ANY CHANGES IN LEVEL BETWEEN 1/4" HIGH MINIMUM AND 1/2" HIGH MAXIMUM SHALL BE BEVELED WITH A SLOPE NOT STEEPER THAN 1:2. CHANGES IN LEVEL OF 1/4" HIGH MAXIMUM SHALL BE PERMITTED TO BE VERTICAL. THERE SHALL BE A FLOOR OR LANDING ON EACH SIDE OF A DOOR. SUCH FLOOR OR LANDING SHALL BE AT THE SAME ELEVATION ON EACH SIDE OF THE DOOR. LANDINGS SHALL BE LEVEL EXCEPT FOR EXTERIOR LANDINGS, WHICH ARE PERMITTED TO HAVE A SLOPE NOT TO EXCEED 0.25 UNIT VERTICAL IN 12 UNITS HORIZONTAL (2-PERCENT SLOPE). ENSURE SMOOTH TRANSITION BETWEEN ADJACENT MATERIALS TO AVOID ANY TRIPPING HAZARDS.

TYPICAL ABBREVIATIONS:

|    |                  |              |      |        |               |            |       |                        |          |                 |       |    |      |
|----|------------------|--------------|------|--------|---------------|------------|-------|------------------------|----------|-----------------|-------|----|------|
| AL | ALUMINUM C.W.    | CURTAIN WALL | DBL  | DOUBLE | F.R.          | FIRE RATED | H.M.  | HOLLOW METAL INSULATED | M.O.     | MASONRY OPENING |       |    |      |
| PL | PLASTIC LAMINATE | PR.          | PAIR | R.O.   | ROUGH OPENING | STL        | STEEL | TEMP                   | TEMPERED | THK             | THICK | WD | WOOD |

NOTE: REFERENCE ARCHITECTURAL FLOOR PLANS FOR DOOR TYPE LOCATIONS AND TYPE OF MATERIALS SURROUNDING DOORWAYS. THE DOOR TYPES SHOWN ARE TYPICAL AND ARE TO BE USED FOR REFERENCE OF INSTALLATION ONLY. CONDITIONS AT EACH LOCATION MAY BE SLIGHTLY DIFFERENT, SIMILAR AND/OR OPPOSITE HAND. CONTRACTOR TO INSTALL ALL COMPONENTS PER MANUFACTURER'S RECOMMENDED STANDARDS WHICH ARE ATTACHED IN MSC. DOCUMENTS. REFER TO OWNER FOR ALL FINAL FRAME, DOOR AND GLAZING FINISH/COLOR SELECTIONS PRIOR TO ORDERING ANY COMPONENT.

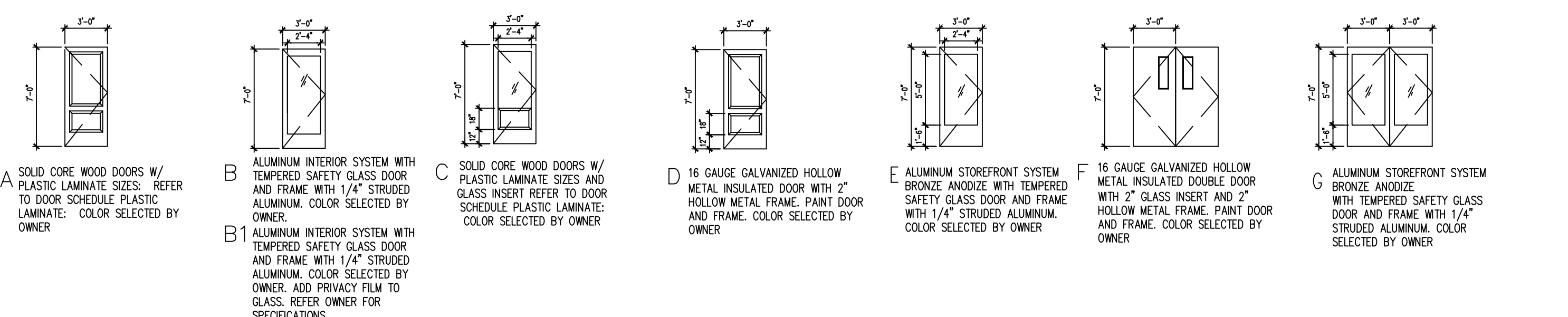

HARDWARE SET #1

DOOR STOP & SILENCERS  
DOOR BOLT

HARDWARE SET #2

DOOR STOP & SILENCERS  
PASSAGE LOCKSET

HARDWARE SET #3

ADA COMPLIANT PANIC BAR  
1/2" MAX. THRESHOLD  
ADA COMPLIANT CLOSER AND WALL STOP

GENERAL HARDWARE NOTES:

- ALL HARDWARE TO BE GRADE 2. VERIFY ALL HARDWARE FINISHES AND COLORS WITH THE OWNER PRIOR TO ORDERING ANY COMPONENT.
- ALL EXTERIOR ENTRANCE/EXITS TO HAVE SIGN STATING "DOORS TO REMAIN UNLOCKED DURING OCCUPANCY", WEATHER STRIPPING AND DRIP CAP.
- CONTRACTOR TO MASTER KEY BUILDING AND PROVIDE (10) COPIES OF MASTER KEY + (3) COPIES OF ALL OTHER KEYS TO OWNER. KEYS ARE TO BE STAMPED WITH THE CORRESPONDING ROOM NUMBER.
- OWNER TO PROVIDE ALL SECURITY, ACCESS CONTROLS, TELEPHONE/DATA WIRING, AND CAMERAS FOR ENTIRE FACILITY.

- ALL EXTERIOR DOORS HARDWARE FINISH WILL BE SATIN NICKEL. SUBMIT SAMPLES TO OWNER FOR APPROVAL.
- ALL INTERIOR DOORS HARDWARE FINISH WILL BE BRIGHT BRASS. SUBMIT SAMPLES TO OWNER FOR APPROVAL.

DOOR AND HARDWARE SCHEDULE

N.T.S

01

| NO. | DESCRIPTION      | DATE     |
|-----|------------------|----------|
| 1   | FINAL SCHEME     | 02.01.19 |
| 2   | REV/FINAL SCHEME | 02.07.19 |
| 3   | CD REVIEW        | 04.15.19 |
| 4   | CD ISSUE         | 06.18.19 |

**Radian**  
ARCHITECTURE  
134 Eldridge Road, Suite 77478  
Sugar Land, Texas 77478  
FAX (713) 933 0912

6/18/19  
REGISTERED ARCHITECT  
STATE OF TEXAS  
10336

|             |          |
|-------------|----------|
| Project No. | 1801.74  |
| Date        | 02/11/19 |
| Drawn by    | JG       |
| Checked by  | NL       |

Sheet No.  
**A-601**  
SCHEDULES

THE MONTESSORIUM AT BELLA TERRA  
23421 FM 1093 RD.  
RICHMOND, TX 77406

THESE PLANS ARE THE PROPERTY OF RADIAN ARCHITECTURE AND ARE SUBJECT TO COPYRIGHT PROTECTION AS AN ARCHITECTURAL WORK. UNDER SECTION 202 OF THE COPYRIGHT ACT, 17 U.S.C. AS AMENDED DECEMBER 1, 1990, AND KNOWN AS THE ARCHITECTURAL COPYRIGHT PROTECTION ACT OF 1990, THE PROTECTION INCLUDES, BUT IS NOT LIMITED TO, THE OVERALL FORM AS WELL AS THE ORIGINAL DESIGN AND ELEMENTS OF THE DESIGN. ANY REPRODUCTION OR TRANSMISSION OF THESE PLANS OR THE FORMS REPRESENTED CALLEGALLY RESULT IN VIOLATION OF SUCH CONSTRUCTION OR BUILDING BEING SEIZED AND/OR RAZED. THE BUILDING CONTRACTOR SHALL BE RESPONSIBLE FOR OBTAINING ALL NECESSARY PERMITS AND APPROVALS FROM ALL APPLICABLE AGENCIES.